



**Heavy Engineering Corporation
Heavy Machine Building Plant
(A Govt of India Enterprises)
Ranchi- 834004 (INDIA)**

Phone : 0651-2401271
0651-2401349
Fax : 0651-2401166, 2401571
E-mail : purhmbp@hecltd.com
Web: www.hecltd.com

Limited Tender

No.HMBP/PUR/12/965261/TC-3423

Dated- 29.08.2012

Dear Sir,

We request you to submit your most competitive offer for the following items / services as per the given schedule:

ENQUIRY SCHEDULE

Sl. no	MAT CODE	DESCRIPTION OF MATERIAL	MATERIAL	QTY (No)	DRG. No.
1	,0046098083	CHAIN ASSLY , Drg no.- 60.98.083	ASSLY	2	60.98.083
2	9333060400	CHAIN DIA 6, L= 400		1	
3	4152264204	DEE SHACKLE Drg no.- 1522.64.204		4	1522.64.204
4	9331065802	WELDED CHAIN, DIA 6, L=5800, IS:3814		7	
5	9330121852	LINK CHAIN DIA 12.5, L=1850,(LINK CHAIN DIA 12.5, L=1850,IS:2429X70, PART II GRADE-30, CALIBRATED.)		4	
6	9330060102	ROUND STEEL SHORT LINK CHAIN LINK ROD DIA 6.3 ELECTRIC BUTT WELDED NON- CALIBRATED MATERIAL GRADE 30 NORMALISED UNPOLISHED L= 100		3	
7	9330061100	ROUND STEEL SHORT LINK CHAIN, LINK ROD DIA = 6.3 ELECTRIC BUTT WELDED NON CALIBRATED MATERIAL GRADE -30 STRESS RELIVED UNPOLISHED=1100 MM. IS :2429-70		20	
8	9330121740	ROUND STEEL SHORT LINK CHAIN, LINK ROD DIA 12MM ELEC. BUTT WELDED, L= 1850 CALIBRATED MATERIAL GRADE 80 NORMALISED UNPOLISHED, IS:6216:1982, SAFE WORKING LOAD 5 TON	STEEL	20	
9	3240411610	SIMPLEX ROLLER CHAIN 08B-1, NO. OF LINKS 161, IS:2403-75		1	
10	3240410840	SIMPLEX ROLLER CHAIN 8.3S, NO. OF LINKS 84, IS:2403-84		1	
11	9331069901	WELD CHAIN WIRE DIA 6, L= 20000,IS: 3814-67	M.S.	4	
12	9331069911	WELD CHAIN WIRE DIA 6, L=22 M, IS:3814-67	M.S.	2	
13	9331069791	WELD CHAIN WIRE Ø 6, L=27M, IS:3814-67	M.S.	4	
14	9331069832	WELD CHAIN WIRE DIA 6, L=32000, IS:3814-67	M.S.	1	

NOTE:-

- 1) The rates quoted must be firm and the offers must remain open for acceptance for three months from the due date of opening of the tender.
- 2) Above mentioned quantity may increase/decrease as per our requirement at the time of placement of order.
- 3) Delivery Period:-Material should be delivered within 04 to 06 Weeks.

4). PAYMENT TERMS:-

Full payment will be made against TAX Invoice/FINAL bill within 60 days of the receipt of supplies at destination duly inspected.

Schedule of Tender receipt by **13.09.2012 upto 1.00 PM**. Opening of Tender on **13.09.2012, at 3.00PM** TENDERS must be submitted in sealed cover with Tender No. and the Due date superscribed on it failing which Tenders may be ignored.

Offer to be submitted in single bid.

NOTE:

1. The rate quoted shall be inclusive of all packing & forwarding. Freight charges to be mentioned Separately, if applicable.
2. The Price quoted by the tenderer should be exclusive of sales tax. The rate and nature of sales tax applicable should be shown separately. Sales tax will be paid to the seller at the rate at which it is liable to be assessed or has actually been assessed on the date of supply provided the transaction of sale is legally liable to sales tax and within the delivery period. Any change on the taxes & duty structure beyond the delivery period will not be considered by HEC.
3. The rates quoted must be firm and the offers made must remain open for acceptance for three months from the date of opening of the tender.
4. Quotations erased or over written are likely to be rejected unless all corrections are authenticated with the tenderer's signature.
5. Delivery date offered must be specified and guaranteed.
6. Full payment will be made against Tax Invoice within 60 days of receipt of supplies at destination duly inspected.
7. The Corporation does not pledge itself to accept the lowest or any tender and reserves to itself the right of accepting the whole or any part of tender or portion of the quantity offered and you shall supply the same at the rate quoted.
8. Supplies will be subject to Inspection by our Inspection wing / or inspection agencies prescribed by us.
9. Order placed as a result of this tender will be subject to the Corporation's General Terms and Conditions of contract which can be down loaded from our website (www.hecltd.com)
10. Corporation reserves the right to call for and examine at any time the books of accounts and other documents and papers of the firm for the purpose of ascertaining whether any excess payments has been made or the firm likely to be received / received undue benefit out of execution of the particular contract.
11. Earnest Money - Earnest money to the extent of 2% of the total value will have to be deposited by demand draft on the State Bank of India, Ranchi Hatia Branch, in favour of Heavy Engineering Corporation Ltd. Ranchi.- 4,
12. Delivery: The time for and the date of delivery of the Stores stipulated in the acceptance of tender shall be deemed to be the essence of the contract and delivery must be completed not later than the dates specified therein.
Otherwise:
 - a) The purchaser to recover from the contractor a sum of 0.5 % per week (completed week) of the price of the stores(upto maximum 10 %) as liquidated damages, which the contractor has failed to deliver as aforesaid or

- b) The purchaser may procure the undelivered stores / similar items from elsewhere, without notice to the contractor at the risk of the contractor without canceling the contract in respect of the consignment not yet due for delivery or,
- c) to cancel the contract or a portion thereof.

13. There is no obligation on our part to accept delayed / late tenders. Tenders received after the due date of opening are liable to be summarily rejected.

Signature of Purchase Executive

(D.K.Naskar)
Sr.DGM/Pur/HMBP/HEC Ltd.

Tender Enquiry No & Date	Description	Enquiry issue date	Tender Opening date & time
No.HMBP/PUR/12/965261/TC-3423, Dated : 29.08.2012	Procurement of Chains	29.08.2012	13.09.2012 at 3.00PM

1522.64.204

the rest

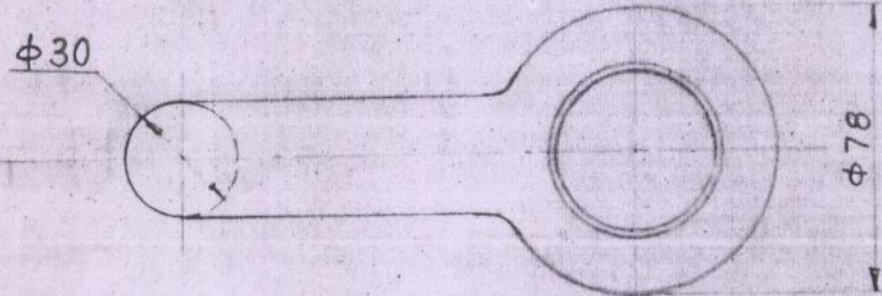
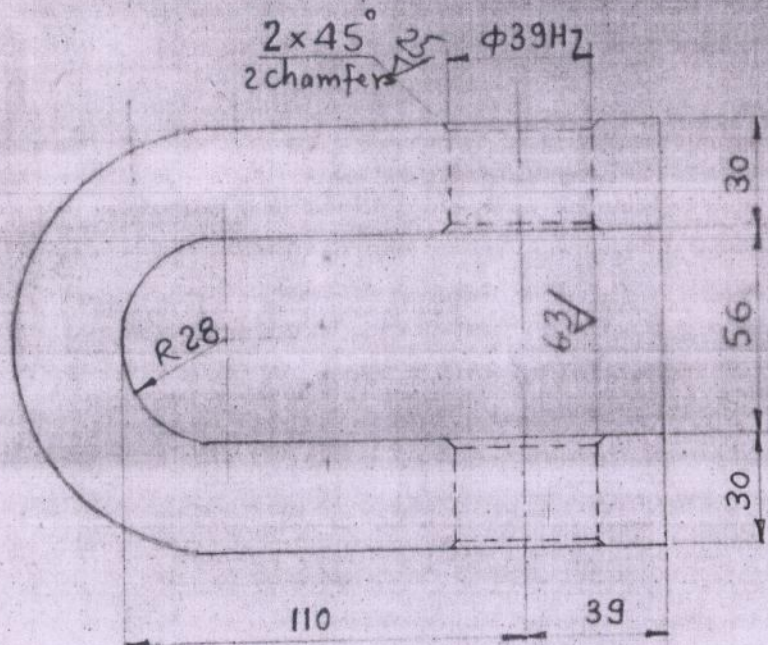

DEE SHACKLE

1522.64.204

MATERIAL :- 45 C8
IS: 7283-92

BUREAU CHIEF

M.M. Prasad

SCALE :- 1:2

WEIGHT IN KG :- 3.2

60.98.083

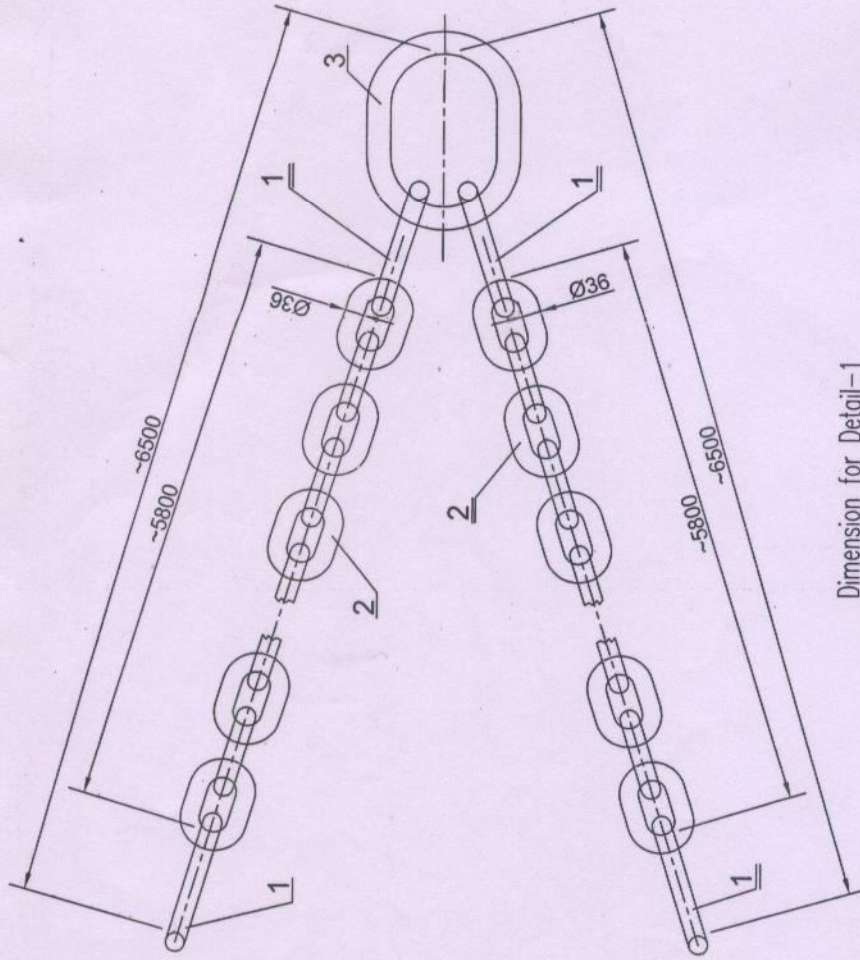

Dimension for Detail-1

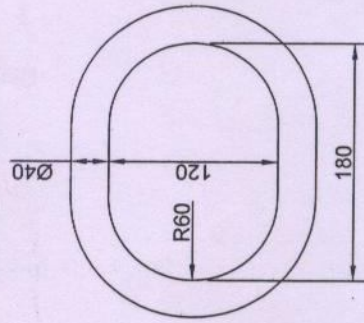

Dimension for Detail-3

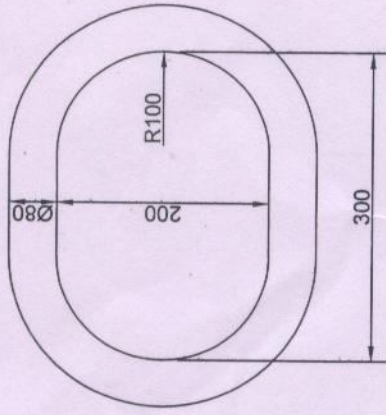

Item No.	Drawing No.	Description	Material	No. Off	per pc.	Total	Remarks
3	60.98.086	Master Link	Alloy Steel IS:6217-82	1	30.00	30.00	No.Drg
2	60.98.085	Short Link Chain Grade-S(6), Non-Calibrated, IS:6217-82, Link dia - 36mm, L=5800 Breaking Load-130 Tons	Assy	2	170.00	340.00	No.Drg
1	60.98.084	End Link	Alloy Steel IS:6217-82	4	6.50	26.00	No.Drg

एच. ई. सी.



Chain Assly

60.98.083

WEIGHT IN KG. - 396.00

SCALE- 1:20

BUREAU-CHIEF

R. PRASAD

GROUP LEADER

P. R. K. SINHA

DESIGNER

P. R. K. SINHA

DRAWN BY

M. KUMAR

60.98.083

Co-ordinate with FFP Co-ordinate with Crane Bureau

June, 12

H.M.B